

BEAR STADIUMS
modular wood systems



RUBNER
holzbau

MODULAR STADIUMS IN GLULAM
2.500, 5.000, 10.000, 15.000, 20.000 SEATS

Advisor e Design: Bear Stadiums, Roma
Engineering and Manufacture: Rubner Holzbau, Bressanone

Our modular stadiums can be increased or decreased according to your Club's seating necessities. Starting from the 2.500 seats Main Stand that includes all standard commodities and facilities, the Stadium can easily be upgraded to 20.000 seats while maintaining maximal comfort for the spectators. Size flexibility reduces maintenance and management expenses while guaranteeing a full stadium.

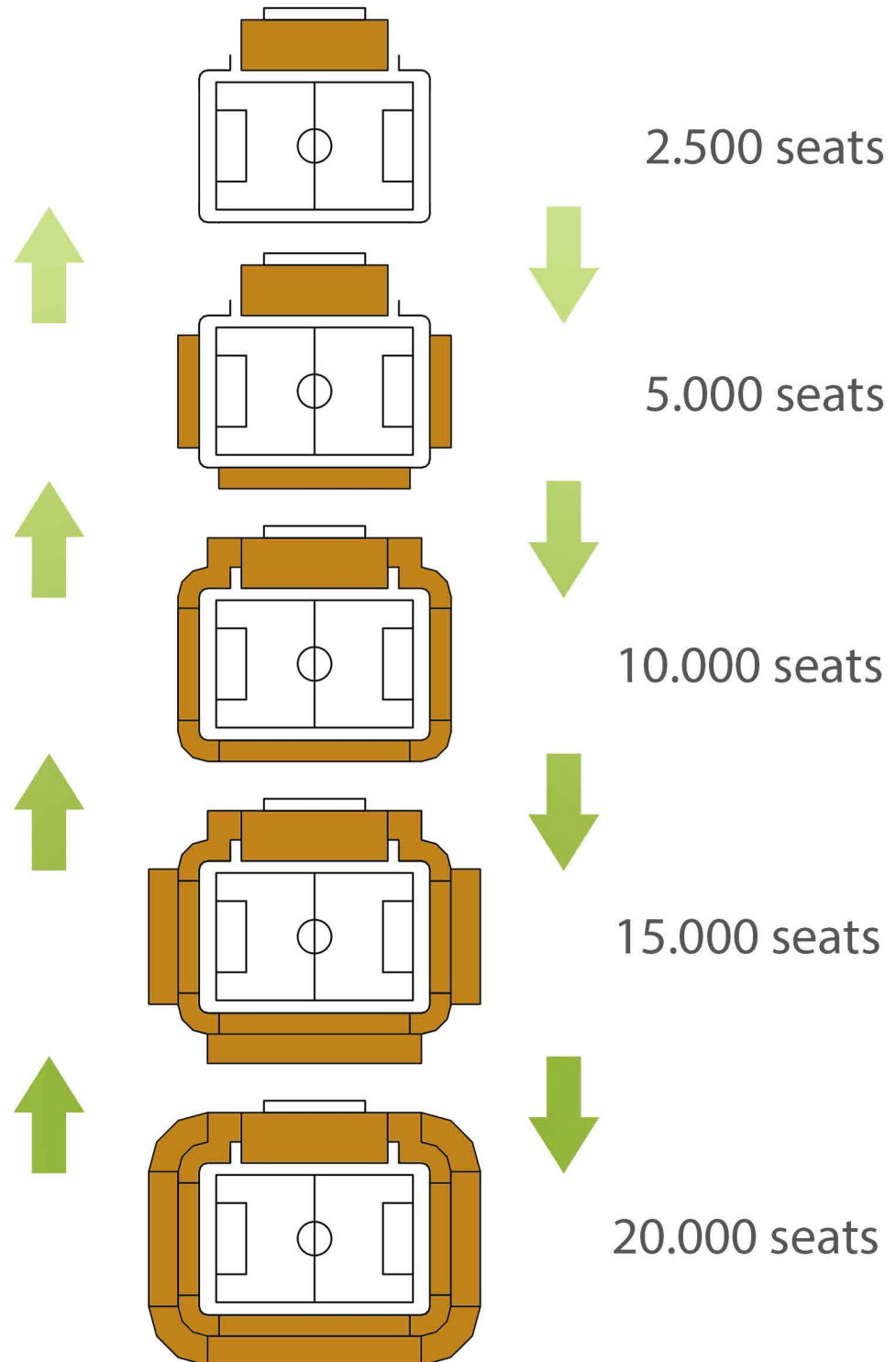

TECHNICAL DATA

- Our Modular Stadiums are produced in Italy, shipped and assembled in any location in the world.
- *They are made of laminated timber and can be assembled in 6 to 8 months.*
- Our modular system comprises of prefabricated Steps with an 80 cm tread and a 40/50 cm riser (registered patent).
- *The steps are waterproofed with polyuria, and present comfortable and well insulated indoor spaces*
- All tip-up seats are fixed at a minimus interaxis of 50 cm as per UEFA /FIFA standards, and are available in the colors of your choice.
- *The roof is sheathed in metal sandwich panneling and can include an energy package with integrated wind turbines and photovoltaic pannels upon request*
- Pitch illumination of 1500 Lux as per UEFA /FIFA standards.
- *The 2,200 sqm Main Stand is on 3 levels, and includes: reception hall, locker rooms, antidoping area, infirmary, conference hall, media room, offices, lounge bar and hospitality area, restaurant, sky boxes and restrooms.*



Wood is a product of Nature.

- It is a beautiful, reliable, renewable building material that has served the purposes of man kind through the ages. It is a light weight, low cost, low heat conductivity, structural element that allows for imaginative, innovative design.
- Building with wood saves energy, protects the environment, saves time, and is enjoyable, both for the constructors and the end user.

GREEN STADIUMS



EFFICIENT
SYSTEMS



LED
LIGHTING



RENEWABLE
ENERGY



WATER
REUSE



LEED
CERTIFICATION

GLUED LAMINATED TIMBER

- *SUSTAINABLE*
- FIRE RESISTENT
- *CONVENIENT*
- INNOVATIVE
- *TRASPORTABLE*
- EASY TO ASSEMBLE



GLUED LAMINATED TIMBER optimizes the structural values of wood. It is a Hi-Tech engineered product, comprised of layers of timber bonded together with durable moisture resistant structural adhesive. The production and assembly of glulam structures entail low energy consumption thus contributing to reduce the emissions of CO₂ in the atmosphere.

**ZERO
CO₂**



Bear Stadiums are built in full respect of the UEFA and FIFA standards and regulations, guaranteeing perfect pitch visibility, comfortable, safe and covered seating, pitch lighting suitable for hd filming, and minimum distance between stands and pitch sideline. Inside the Main Stand, the stadiums layout include Team A and B king size locker rooms with all facilities, conference hall, media and interview spaces, offices, anti-doping and infirmary area, as well as all the best services for the public: bars, restaurants, hospitality lounge, sky boxes.

FIFA/UEFA STANDARDS



MINIMUM
INTER-AXIS
50 CM



PERFECT
VISIBILITY



COMMUNITY
FACILITIES



TOTALLY
ACCESSIBLE



ALL SEATS
COVERED

RUBNER HOLZBAU provides and assembles the stadiums. The Company guarantees the engineering, logistics, and shipment activities, and coordinates the works with the **Local Contractor** as per **Technical Specifications Book**.

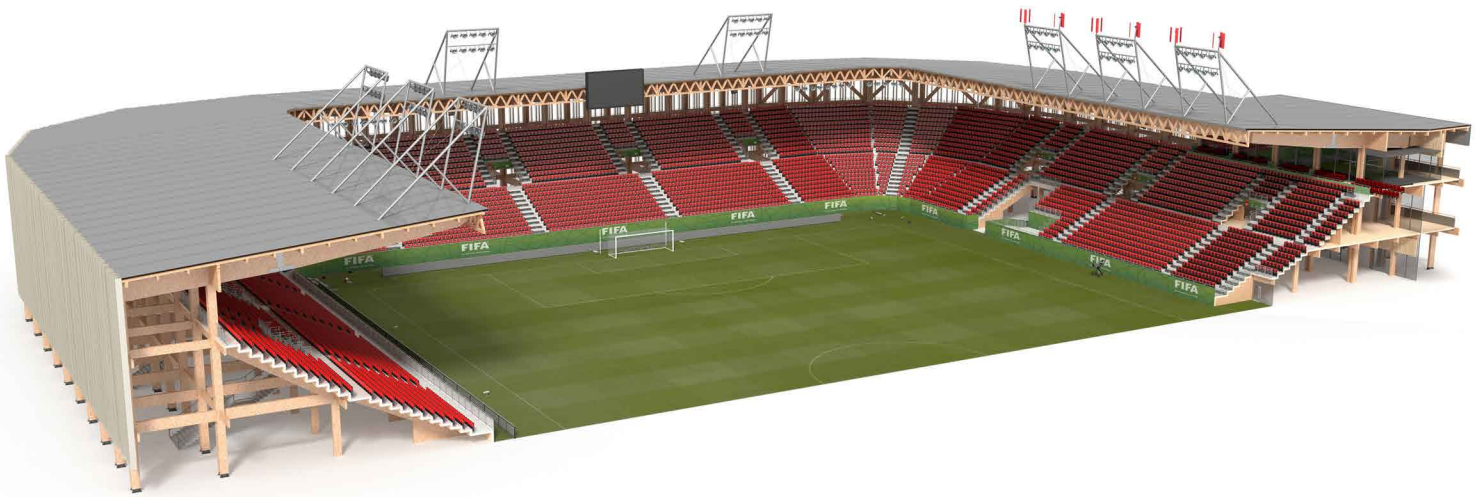

Bear Stadiums - Rubner Holzbau

RUBNER HOLZBAU

- Stadium structures in laminated timber
- Steps in laminated timber (registred patent)
- *Waterproofing in polyurea on all stands*
- Metal Joint and anchor systems
- Railings, handrails, stairs
- *Flat roof covered in metal sandwich paneling*
- Tip-up seats in colors of your choice
- Football pitch illumination (upon request)
- *Integrated wind turbines and fotovoltaic panels (upon request)*
- Main Stand 2,200 sqm: reception hall, locker rooms, antidoping area, infirmary, conference hall, media room, offices, lounge bar and hospitality area, restaurant, sky boxes, restrooms.
- Kiosk bars and restrooms containers
- Architectural Design, Interior Design, Engineering
- Technical Specifications Book

LOCAL CONTRACTOR

- *Planning permission, building permits and others*
- Earthworks and Foundations
- Drainage and *Pitch 105 x 68 in natural or syntetic turf*
- Fences and turnstiles
- *Internal works and finishings*
- hydraulic, electrical, heating systems
- Final testing

TIMING

RUBNER HOLZBAU

LOCAL CONTRACTOR

	DAY	
PRECONTRACT	1	
feasibility study	15	
CONTRACT	45	earthworks
PRODUCTION	60	foundations
SHIPMENT	90	pitch 105 x 68 m
ASSEMBLY	120	hydr/elect/heat systems
assembly	150	fixtures and internal works
assembly	180	fixtures and internal works
stadium 2.500 seats ready	210	fences and turnstiles
stadium 5.000 seats ready	240	finishing and final tests
stadium 10.000 seats ready	270	finishing and final tests
stadium 15.000 seats ready	300	finishing and final tests
stadium 20.000 seats ready	330	finishing and final tests

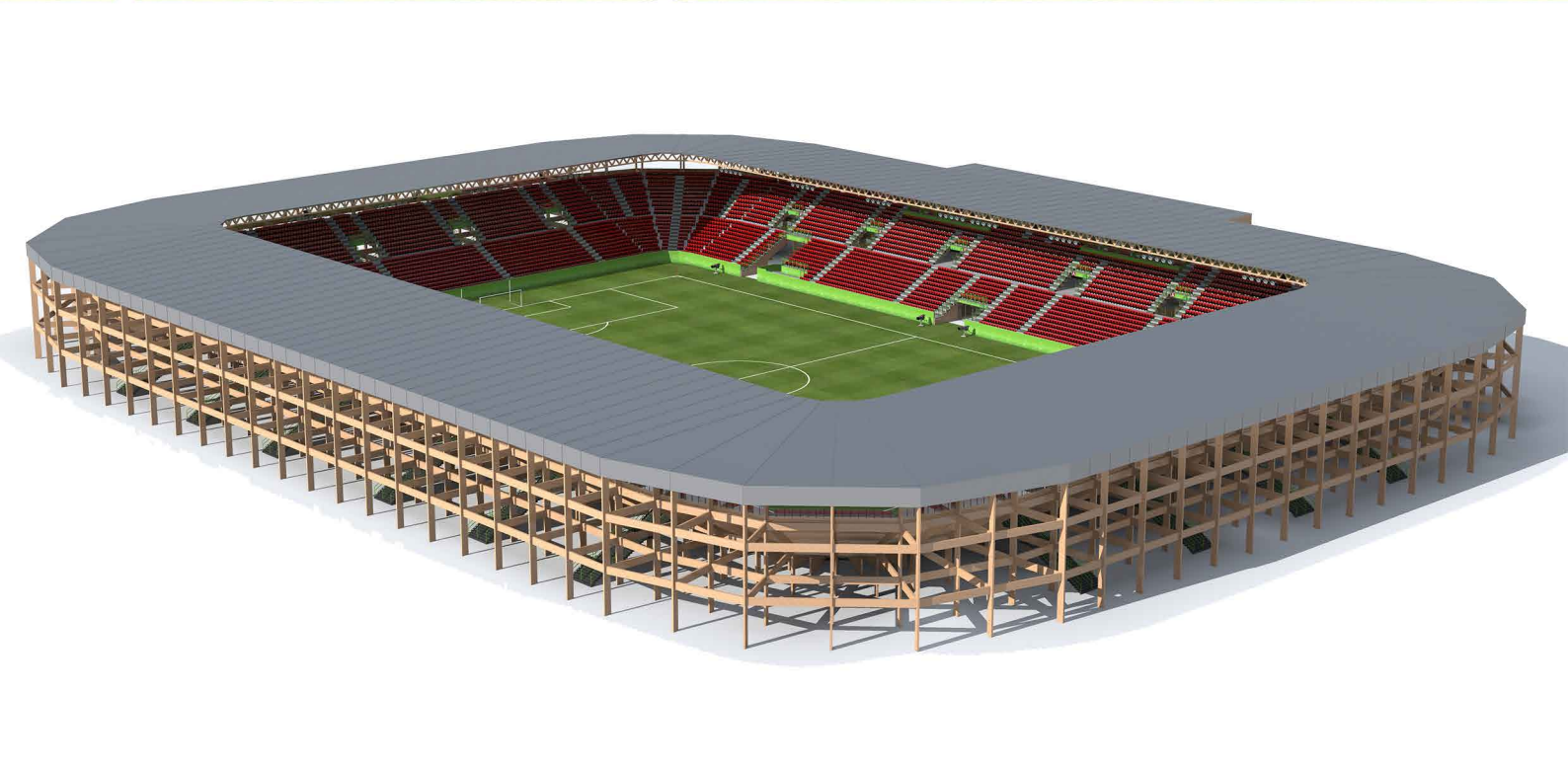

Bear Stadiums - Rubner Holzbau

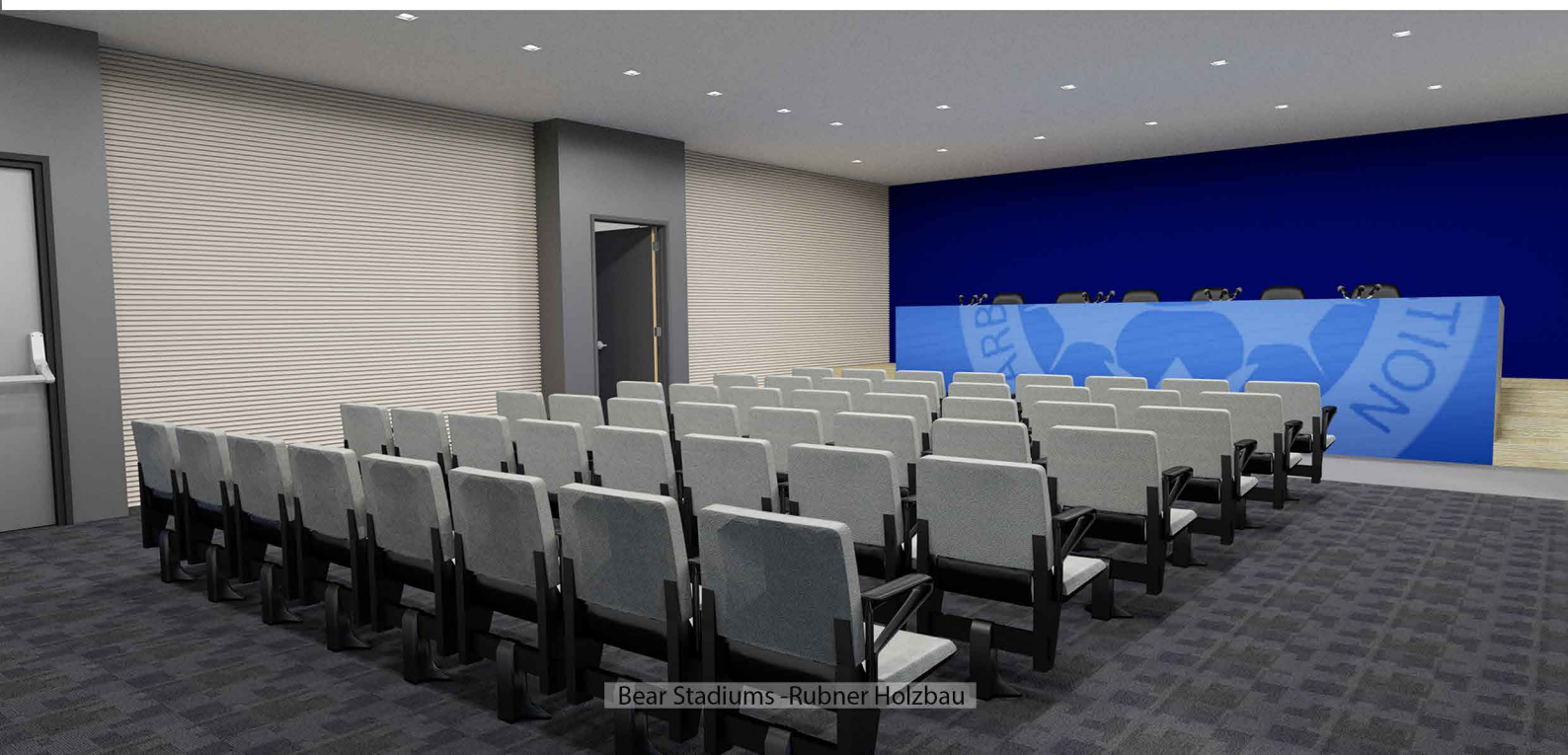

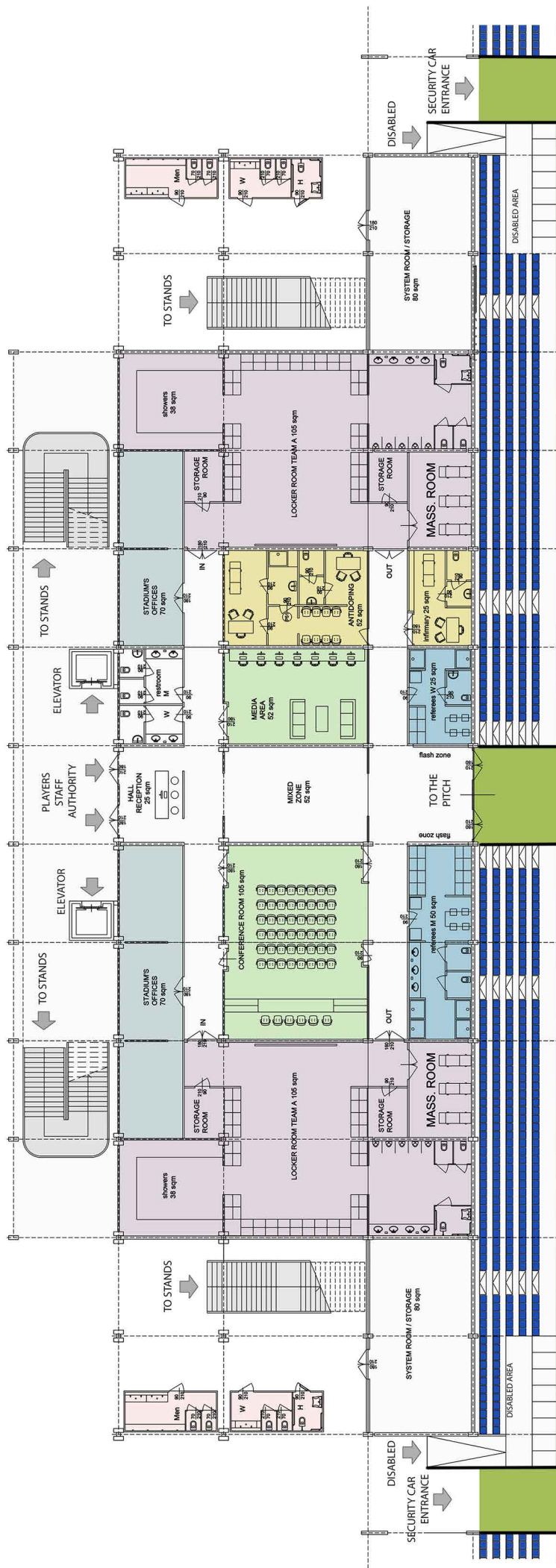

MAIN STAND - GROUND FLOOR

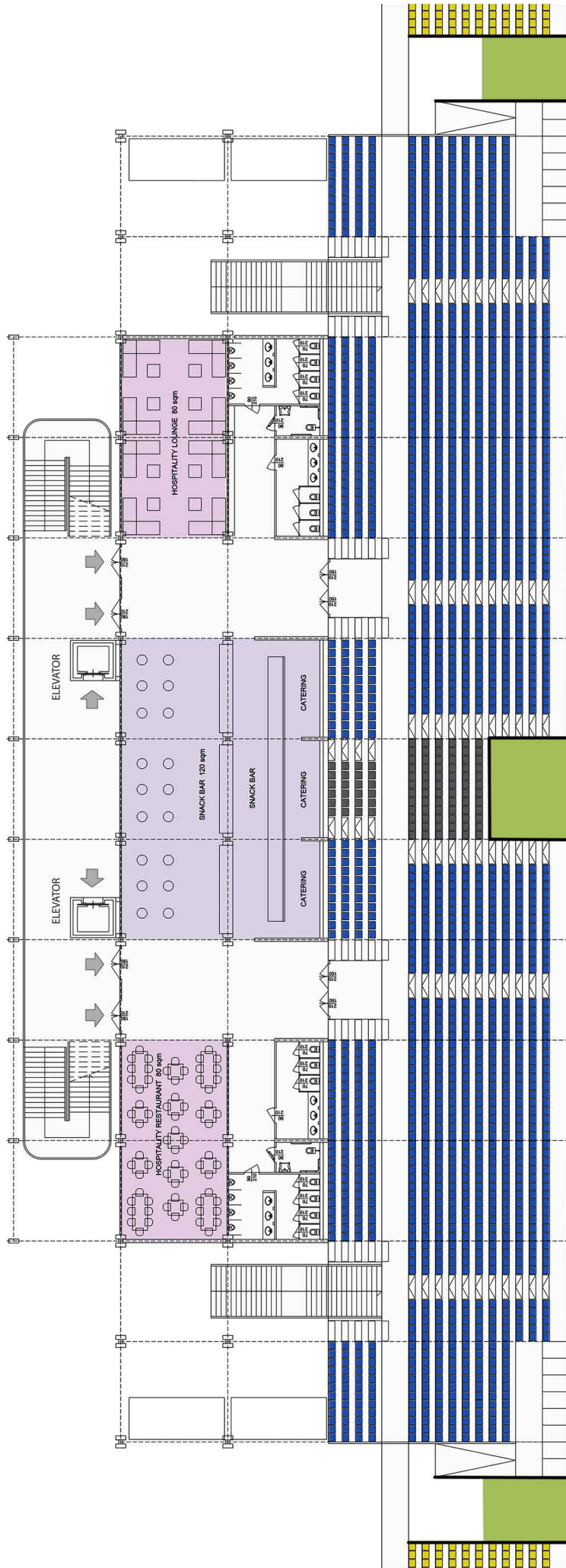

MAIN STAND - FIRST FLOOR

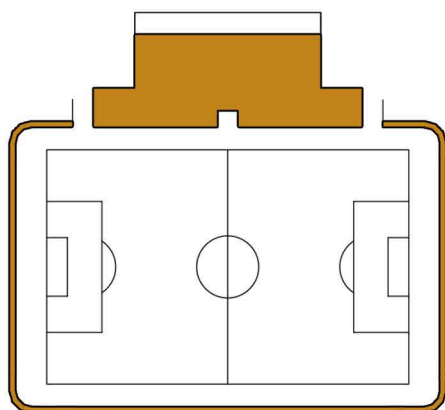

BEAR STADIUMS
modular wood systems

RUBNER
holzbau

2.500 SEATS STADIUM

PITCH DIMENSION 105 X 68 mt

MAIN STAND 2.500 SEATS

Stands distance from the touch line 6,60 mt

Fences distance from the goal line 9,10 mt

Main Stand (west side) 2.200 sqm

GROUND LEVEL 1.150 sqm:

Hall reception	40 sqm
Stadium offices	120 sqm
Media work area	50 sqm
Conference hall	105 sqm
Antidoping area	50 sqm
Infirmary	25 sqm
Offices delegate UEFA/FIFA	25 sqm
Lockers referees (ladies/gents)	25 + 50 sqm
Locker room team A	225 sqm
Locker room team B	225 sqm
Mixed zone	50 sqm
hallways and common areas	160 sqm

FIRST LEVEL 650 sqm:

Restaurant/bar/hospitality	380 sqm
Restroom	130 sqm
hallways and common areas	140 sqm

SECOND LEVEL 400 sqm:

sky boxes/control room	240 sqm
Restrooms	60 sqm
hallways and common areas	100 sqm



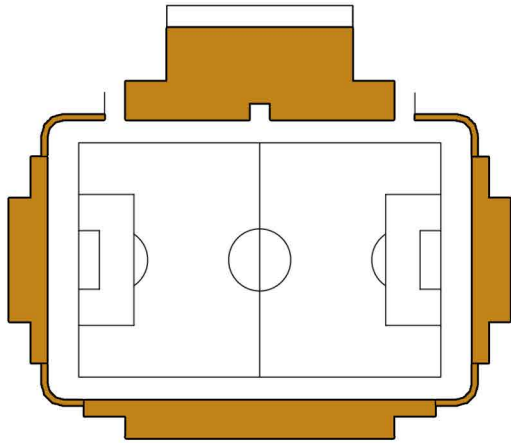

BEAR STADIUMS
modular wood systems

RUBNER
holzbau

5.000 SEATS STADIUM

PITCH DIMENSION 105 X 68 mt

MAIN STAND	2.500 SEATS
NORTH STAND	650 SEATS
SOUTH STAND	650 SEATS
EAST STAND	1.200 SEATS

Stands distance from the touch line 6,60 mt

Stands distance from the goal line 9,10 mt

Main Stand (west side) 2.200 sqm

GROUND LEVEL 1.150 sqm:

Hall reception	40 sqm
Stadium offices	120 sqm
Media work area	50 sqm
Conference hall	105 sqm
Antidoping area	50 sqm
Infirmary	25 sqm
Offices delegate UEFA/FIFA	25 sqm
Lockers referees (ladies/gents)	25 + 50 sqm
Locker room team A	225 sqm
Locker room team B	225 sqm
Mixed zone	50 sqm
hallways and common areas	160 sqm

FIRST LEVEL 650 sqm:

Restaurant/bar/hospitality	380 sqm
Restroom	130 sqm
hallways and common areas	140 sqm

SECOND LEVEL 400 sqm:

sky boxes/control room	240 sqm
Restrooms	60 sqm
hallways and common areas	100 sqm

Grand Stand (north/south/east side)

12 prefabricated restrooms	180 sqm
04 prefabricated kiosk bars	60 sqm



Bear Stadiums - Rubner Holzbau

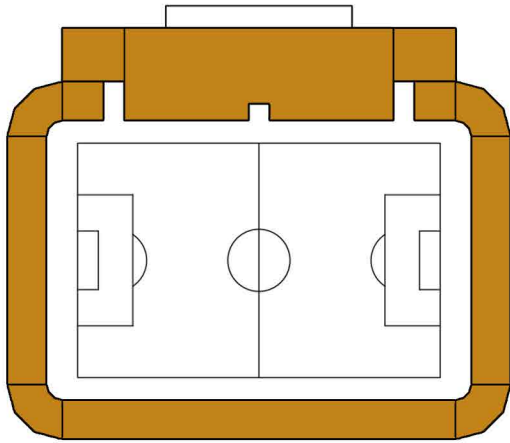

BEAR STADIUMS
modular wood systems

RUBNER
holzbau

10.000 SEATS STADIUM

PITCH DIMENSION 105 X 68 mt

MAIN STAND 4.000 SEATS
NORTH STAND 1.250 SEATS
SOUTH STAND 1.250 SEATS
EAST STAND 2.000 SEATS
1.500 SEATS

Stands distance from the touch line 6,60 mt
Stands distance from the goal line 9,10 mt

Main Stand (west side) 2.200 sqm

GROUND LEVEL 1.150 sqm:

Hall reception	40 sqm
Stadium offices	120 sqm
Media work area	50 sqm
Conference hall	105 sqm
Antidoping area	50 sqm
Infirmary	25 sqm
Offices delegate UEFA/FIFA	25 sqm
Lockers referees (ladies/gents)	25 + 50 sqm
Locker room team A	225 sqm
Locker room team B	225 sqm
Mixed zone	50 sqm
hallways and common areas	160 sqm

FIRST LEVEL 650 sqm:

Restaurant/bar/hospitality	380 sqm
Restroom	130 sqm
hallways and common areas	140 sqm

SECOND LEVEL 400 sqm:

sky boxes/control room	240 sqm
Restrooms	60 sqm
hallways and common areas	100 sqm

Grand Stand (north/south/east side)

12 prefabricated restrooms	180 sqm
04 prefabricated kiosk bars	60 sqm



Bear Stadiums - Rubner Holzbau

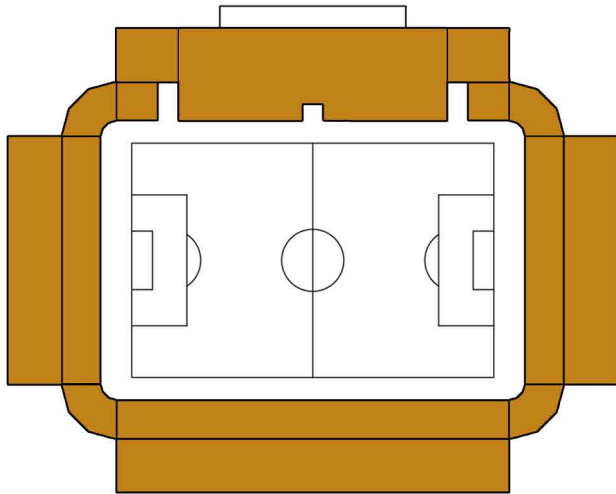

BEAR STADIUMS
modular wood systems

RUBNER
holzbau

15.000 SEATS STADIUM

PITCH DIMENSION 105 X 68 mt

MAIN STAND	4.000 SEATS
NORTH STAND	2.750 SEATS
SOUTH STAND	2.750 SEATS
EAST STAND	4.500 SEATS
CORNER STANDS	1.000 SEATS

Stands distance from the touch line 6,60 mt
Stands distance from the goal line 9,10 mt

Main Stand (west side) 2.200 sqm

GROUND LEVEL 1.150 sqm:

Hall reception	40 sqm
Stadium offices	120 sqm
Media work area	50 sqm
Conference hall	105 sqm
Antidoping area	50 sqm
Infirmary	25 sqm
Offices delegate UEFA/FIFA	25 sqm
Lockers referees (ladies/gents)	25 + 50 sqm
Locker room team A	225 sqm
Locker room team B	225 sqm
Mixed zone	50 sqm
hallways and common areas	160 sqm

FIRST LEVEL 650 sqm:

Restaurant/bar/hospitality	380 sqm
Restroom	130 sqm
hallways and common areas	140 sqm

SECOND LEVEL 400 sqm:

sky boxes/control room	240 sqm
Restrooms	60 sqm
hallways and common areas	100 sqm

Grand Stand (north/south/east side)

12 prefabricated restrooms	180 sqm
04 prefabricated kiosk bars	60 sqm



Bear Stadiums - Rubner Holzbau

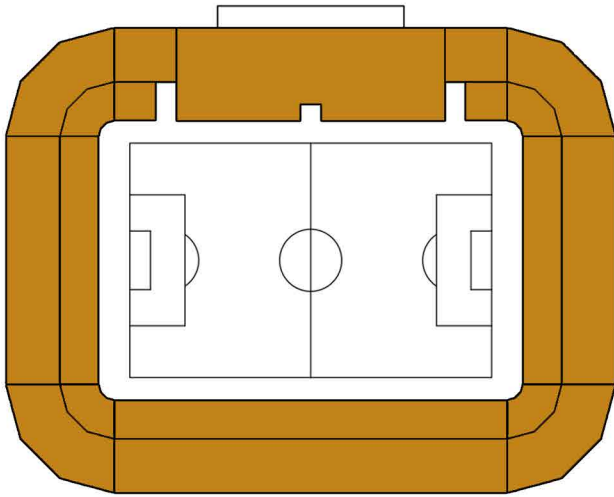

BEAR STADIUMS
modular wood systems™

RUBNER
holzbau

20.000 SEATS STADIUM

PITCH DIMENSION 105 X 68 mt

MAIN STAND	4.200 SEATS
NORTH STAND	3.500 SEATS
SOUTH STAND	3.500 SEATS
EAST STAND	4.800 SEATS
CORNER STANDS	4.000 SEATS

Stands distance from the touch line 6,60 mt
Stands distance from the goal line 9,10 mt

Main Stand (west side) 2.200 sqm

GROUND LEVEL 1.150 sqm:

Hall reception	40 sqm
Stadium offices	120 sqm
Media work area	50 sqm
Conference hall	105 sqm
Antidoping area	50 sqm
Infirmary	25 sqm
Offices delegate UEFA/FIFA	25 sqm
Lockers referees (ladies/gents)	25 + 50 sqm
Locker room team A	225 sqm
Locker room team B	225 sqm
Mixed zone	50 sqm
hallways and common areas	160 sqm

FIRST LEVEL 650 sqm:

Restaurant/bar/hospitality	380 sqm
Restroom	130 sqm
hallways and common areas	140 sqm

SECOND LEVEL 400 sqm:

sky boxes/control room	240 sqm
Restrooms	60 sqm
hallways and common areas	100 sqm

Grand Stand (north/south/east side)

12 prefabricated restrooms	180 sqm
04 prefabricated kiosk bars	60 sqm



Bear Stadiums - Rubner Holzbau

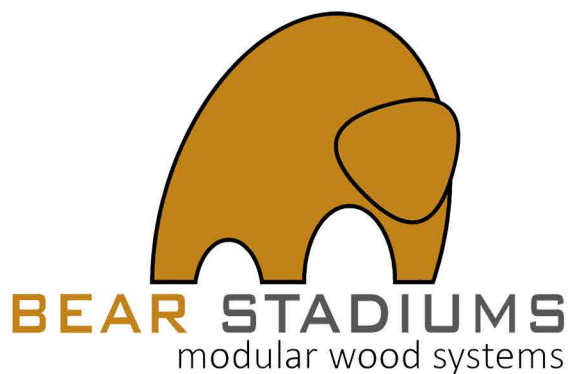

Advisor e Design:

BEAR STADIUMS S.r.l.
Viale Giulio Cesare, 2
I-00192 Roma
Tel. +39 335 5947910
info@bearstadiums.com



Engineering e Costruzione:

RUBNER HOLZBAU S.p.A.
Via A. Ammon, 12
I-39042 Bressanone (BZ)
Tel. +39 0472 822 666
Fax +39 0472 822 600
holzbau.brixen@rubner.com



SALES & Business Development:

NEW CONCEPT STADIUMS
20-22 Wenlock Road
N1 7GU London
Tel. +39335463404
info@newconceptstadiums.com